

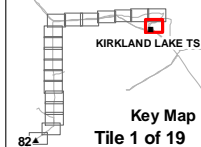

Produced By: Hydro One Networks Inc., GIS Services
   
 Date: May 25, 2022
   
 Map22-047\_K4\_Line\_Refurbishment\_Project\_Tile\_Map\_Ortho
   

 (C) Copyright Hydro One Networks Inc. All rights reserved. No part of this drawing may be redistributed or reproduced in any form by any photographic, electronic, mechanical or any other means or used in any information storage or retrieval system. Neither Hydro One Networks Inc. nor any of its affiliates assumes liability for any errors or omissions.
   
 Produced by Hydro One under license with the Ontario Ministry of Natural Resources
   
 © Queen's Printer for Ontario, 2021.
   
 NOT TO BE REPRODUCED OR REDISTRIBUTED CONFIDENTIAL TO HYDRO ONE NETWORKS INC.



- Transformer Station
- New Structure (Replacement/Relocation)
- New Temporary
- Existing Structure
- Existing 115 kV Transmission Line (K4)
- New Parallel Replacement 115 kV Transmission Line (K4)
- Other Transmission Lines

- Highway
- Road
- Railway
- Pipeline
- Watercourse
- Waterbody
- Municipal Boundary

**Circuit K4 Line Refurbishment - Kirkland Lake TS to Structure 82**

1:2,500
 
0
25
50
m



  
 Produced By: Hydro One Networks Inc., GIS Services
   
 Date: May 25, 2022
   
 Map22-047\_K4\_Line\_Refurbishment\_Project\_Tile\_Map\_Ortho
   

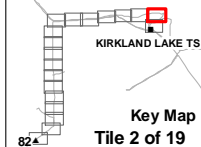

 (C) Copyright Hydro One Networks Inc. All rights reserved. No part of this drawing may be redistributed or reproduced in any form by any photographic, electronic, mechanical or any other means or used in any information storage or retrieval system. Neither Hydro One Networks Inc. nor any of its affiliates assumes liability for any errors or omissions.
 
  

 Produced by Hydro One under license with the Ontario Ministry of Natural Resources © Queen's Printer for Ontario, 2021.
 
  
 NOT TO BE REPRODUCED OR REDISTRIBUTED CONFIDENTIAL TO HYDRO ONE NETWORKS INC.

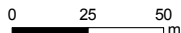

-  Transformer Station
-  New Structure (Replacement/Relocation)
-  New Temporary
-  Existing Structure
-  Existing 115 kV Transmission Line (K4)
-  New Parallel Replacement 115 kV Transmission Line (K4)
-  Other Transmission Lines
-  Highway
-  Road
-  Railway
-  Pipeline
-  Watercourse
-  Waterbody
-  Municipal Boundary

**Circuit K4 Line Refurbishment - Kirkland Lake TS to Structure 82**

1:2,500
   

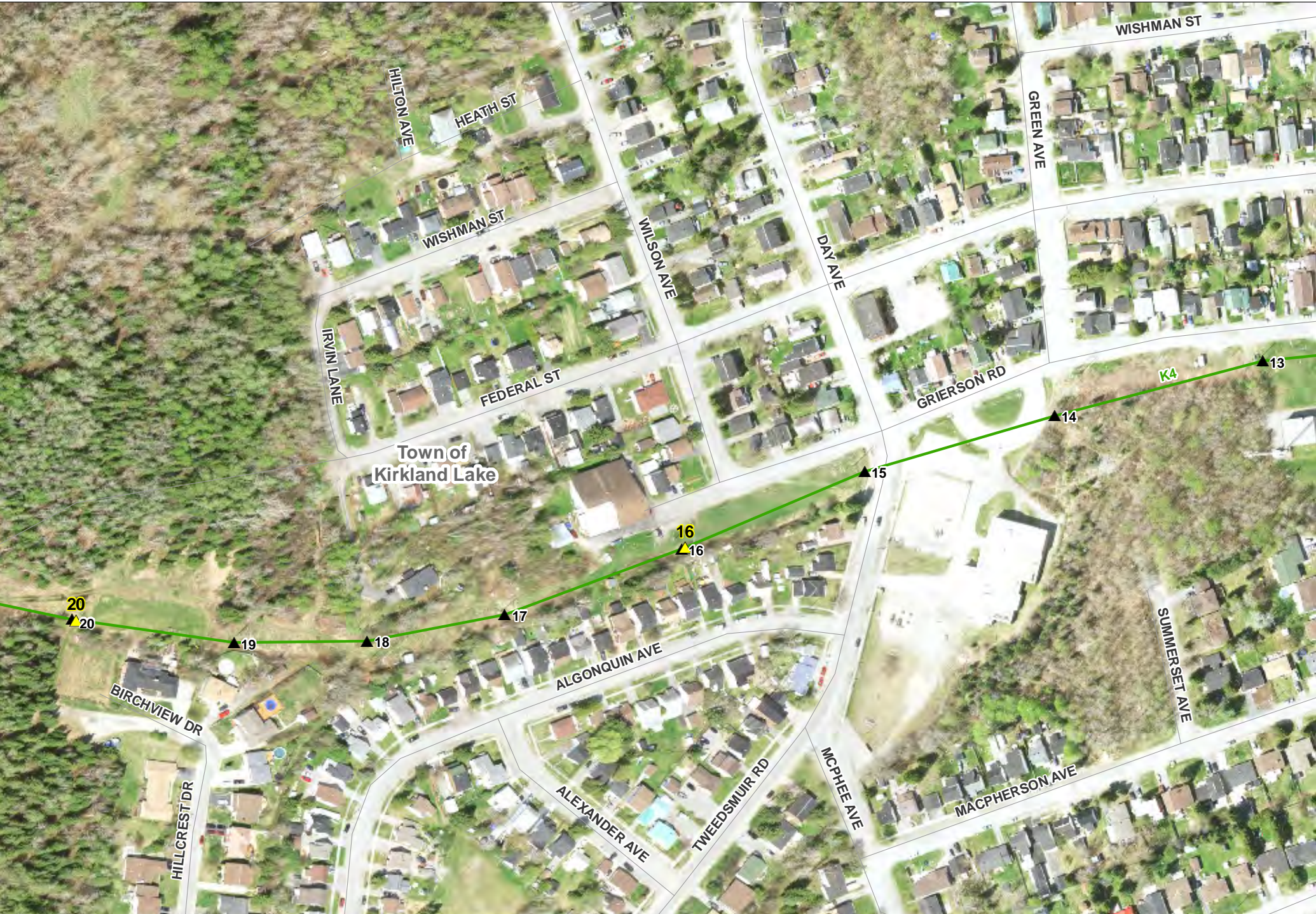



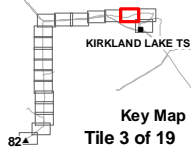

  
 Produced By: Hydro One Networks Inc., GIS Services
   
 Date: May 25, 2022
   
 Map22-047\_K4\_Line\_Refurbishment\_Project\_Tile\_Map\_Ortho
   

 (C) Copyright Hydro One Networks Inc. All rights reserved. No part of this drawing may be
 redistributed or reproduced in any form by any photographic, electronic, mechanical or any
 other means or used in any information storage or retrieval system. Neither Hydro One
 Networks Inc. nor any of its affiliates assumes liability for any errors or omissions.
 Produced by Hydro One under license with the Ontario Ministry of Natural Resources
 © Queen's Printer for Ontario, 2021.
 NO TO BE REPRODUCED OR REDISTRIBUTED CONFIDENTIAL TO HYDRO ONE NETWORKS INC.



- Transformer Station
- New Structure (Replacement/Relocation)
- New Temporary
- Existing Structure
- Existing 115 kV Transmission Line (K4)
- New Parallel Replacement 115 kV Transmission Line (K4)
- Other Transmission Lines

- Highway
- Road
- Railway
- Pipeline
- Watercourse
- Waterbody
- Municipal Boundary

**Circuit K4 Line Refurbishment - Kirkland Lake TS to Structure 82**

1:2,500
 



 0    25    50 m



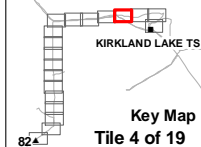

  
 Produced By: Hydro One Networks Inc., GIS Services  
 Date: May 25, 2022  
 Map22-047\_K4\_Line\_Refurbishment\_Project\_Tile\_Map\_Ortho  
 (C) Copyright Hydro One Networks Inc. All rights reserved. No part of this drawing may be redistributed or reproduced in any form by any photographic, electronic, mechanical or any other means or used in any illustration, storage or retrieval system. Neither Hydro One Networks Inc. nor any of its affiliates assumes liability for any errors or omissions.  
 Produced by Hydro One under license with the Ontario Ministry of Natural Resources © Queen's Printer for Ontario, 2021.  
 NOT TO BE REPRODUCED OR REDISTRIBUTED CONFIDENTIAL TO HYDRO ONE NETWORKS INC.

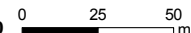

- Transformer Station
- New Structure (Replacement/Relocation)
- New Temporary
- Existing Structure
- Existing 115 kV Transmission Line (K4)
- New Parallel Replacement 115 kV Transmission Line (K4)
- Other Transmission Lines

- Highway
- Road
- Railway
- Pipeline
- Watercourse
- Waterbody
- Municipal Boundary



**Circuit K4 Line Refurbishment - Kirkland Lake TS to Structure 82**  
 1:2,500  
  



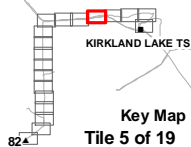

  
 Produced By: Hydro One Networks Inc., GIS Services  
 Date: May 25, 2022  
 Map22-047\_K4\_Line\_Refurbishment\_Projct\_Tile\_Map\_Ortho  
 (C) Copyright Hydro One Networks Inc. All rights reserved. No part of this drawing may be redistributed or reproduced in any form by any photographic, electronic, mechanical or any other means or used in any information storage or retrieval systems. Neither Hydro One Networks Inc. nor any of its affiliates assumes liability for any errors or omissions.  
 Produced by Hydro One under license with the Ontario Ministry of Natural Resources © Queen's Printer for Ontario, 2021.  
 NOT TO BE REPRODUCED OR REDISTRIBUTED CONFIDENTIAL TO HYDRO ONE NETWORKS INC.

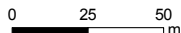

- |  |  |  |  |
|--|--|--|--|
| <ul style="list-style-type: none"> <li>■ Transformer Station</li> <li>▲ New Structure (Replacement/Relocation)</li> <li>▲ New Temporary</li> <li>▲ Existing Structure</li> </ul> | <ul style="list-style-type: none"> <li>— Existing 115 kV Transmission Line (K4)</li> <li>— New Parallel Replacement 115 kV Transmission Line (K4)</li> <li>--- Other Transmission Lines</li> </ul> | <ul style="list-style-type: none"> <li>— Highway</li> <li>— Road</li> <li>— Railway</li> <li>--- Pipeline</li> </ul> | <ul style="list-style-type: none"> <li>— Watercourse</li> <li>— Waterbody</li> <li>▭ Municipal Boundary</li> </ul> |
|--|--|--|--|

**Circuit K4 Line Refurbishment - Kirkland Lake TS to Structure 82**  
 1:2,500  
  



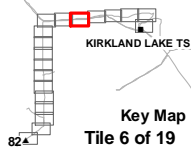

  
 Produced By: Hydro One Networks Inc., GIS Services
   
 Date: May 25, 2022
   
 Map22-047\_K4\_Line\_Refurbishment\_Projct\_Tile\_Map\_Ortho
   

 (C) Copyright Hydro One Networks Inc. All rights reserved. No part of this drawing may be redistributed or reproduced in any form by any photographic, electronic, mechanical or any other means or used in any information storage or retrieval system. Neither Hydro One Networks Inc. nor any of its affiliates assumes liability for any errors or omissions.
   
 Produced by Hydro One under license with the Ontario Ministry of Natural Resources
   
 © Queen's Printer for Ontario, 2021.
   
 NOT TO BE REPRODUCED OR REDISTRIBUTED CONFIDENTIAL TO HYDRO ONE NETWORKS INC.

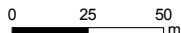

- |  |  |  |  |
|--|--|--|--|
| <ul style="list-style-type: none"> <li>■ Transformer Station</li> <li>▲ New Structure (Replacement/Relocation)</li> <li>▲ New Temporary</li> <li>▲ Existing Structure</li> </ul> | <ul style="list-style-type: none"> <li>— Existing 115 kV Transmission Line (K4)</li> <li>— New Parallel Replacement 115 kV Transmission Line (K4)</li> <li>- - - Other Transmission Lines</li> </ul> | <ul style="list-style-type: none"> <li>— Highway</li> <li>— Road</li> <li>— Railway</li> <li>- - - Pipeline</li> </ul> | <ul style="list-style-type: none"> <li>— Watercourse</li> <li>— Waterbody</li> <li>▭ Municipal Boundary</li> </ul> |
|--|--|--|--|

**Circuit K4 Line Refurbishment - Kirkland Lake TS to Structure 82**

1:2,500
   

  

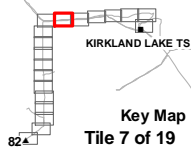

  
 Produced By: Hydro One Networks Inc., GIS Services  
 Date: May 25, 2022  
 Map22-047\_K4\_Line\_Refurbishment\_Projct\_Tile\_Map\_Ortho  
 (C) Copyright Hydro One Networks Inc. All rights reserved. No part of this drawing may be redistributed or reproduced in any form by any photographic, electronic, mechanical or any other means or used in any information storage or retrieval system. Neither Hydro One Networks Inc. nor any of its affiliates assumes liability for any errors or omissions.  
 Produced by Hydro One under license with the Ontario Ministry of Natural Resources © Queen's Printer for Ontario, 2021.  
 NOT TO BE REPRODUCED OR REDISTRIBUTED CONFIDENTIAL TO HYDRO ONE NETWORKS INC.



- Transformer Station
- ▲ New Structure (Replacement/Relocation)
- ▲ New Temporary
- ▲ Existing Structure

- Existing 115 kV Transmission Line (K4)
- New Parallel Replacement 115 kV Transmission Line (K4)
- - - Other Transmission Lines

- Highway
- Road
- Railway
- - - Pipeline

- Watercourse
- Waterbody
- Municipal Boundary

**Circuit K4 Line Refurbishment - Kirkland Lake TS to Structure 82**

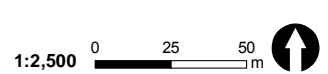

Town of Kirkland Lake



hydro One  
 Produced By: Hydro One Networks Inc., GIS Services  
 Date: May 25, 2022  
 Map22-047\_K4\_Line\_Refurbishment\_Project\_Tile\_Map\_Ortho  
 (C) Copyright Hydro One Networks Inc. All rights reserved. No part of this drawing may be redistributed or reproduced in any form by any photographic, electronic, mechanical or any other means or used in any information storage or retrieval system. Neither Hydro One Networks Inc. nor any of its affiliates assumes liability for any errors or omissions.  
 Produced by Hydro One under license with the Ontario Ministry of Natural Resources © Queen's Printer for Ontario, 2021.  
 NOT TO BE REPRODUCED OR REDISTRIBUTED CONFIDENTIAL TO HYDRO ONE NETWORKS INC.

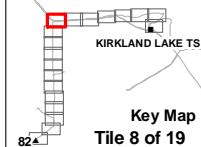

<ul style="list-style-type: none"> <li>■ Transformer Station</li> <li>▲ New Structure (Replacement/Relocation)</li> <li>▲ New Temporary</li> <li>▲ Existing Structure</li> </ul>	<ul style="list-style-type: none"> <li>— Existing 115 kV Transmission Line (K4)</li> <li>— New Parallel Replacement 115 kV Transmission Line (K4)</li> </ul>	<ul style="list-style-type: none"> <li>— Highway</li> <li>— Road</li> <li>— Railway</li> <li>— Pipeline</li> </ul>	<ul style="list-style-type: none"> <li>— Watercourse</li> <li>— Waterbody</li> <li>— Municipal Boundary</li> </ul>
--	--	--	--

**Circuit K4 Line Refurbishment - Kirkland Lake TS to Structure 82**

1:2,500 0 25 50 m



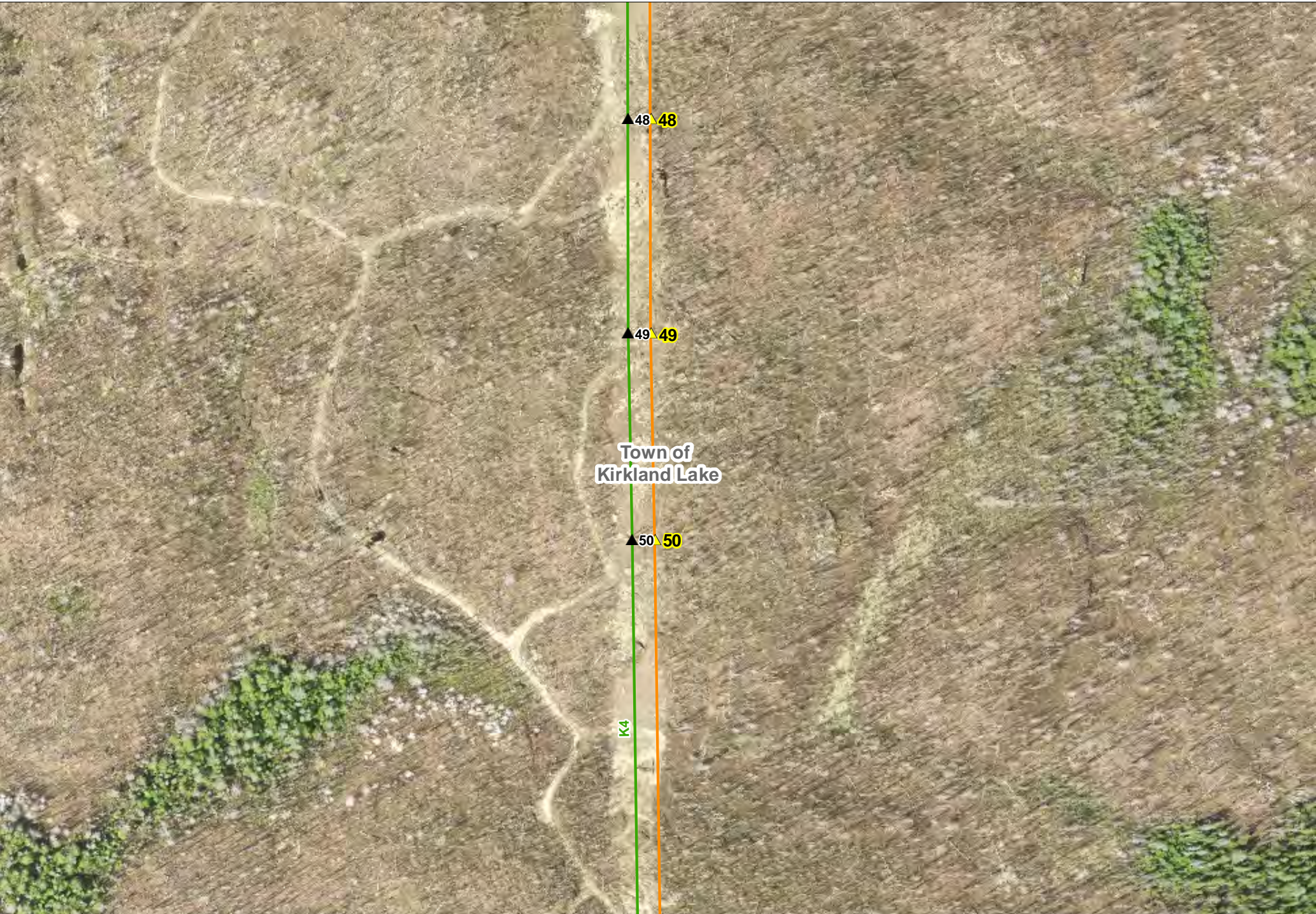

Town of  
Kirkland Lake

K4

▲ 48 ▲ 48

▲ 49 ▲ 49

▲ 50 ▲ 50

  
 Produced By: Hydro One Networks Inc., GIS Services  
 Date: May 25, 2022  
 Map22-047\_K4\_Line\_Refurbishment\_Projct\_Tile\_Map\_Ortho  
 (C) Copyright Hydro One Networks Inc. All rights reserved. No part of this drawing may be redistributed or reproduced in any form by any photographic, electronic, mechanical or any other means or used in any information storage or retrieval system. Neither Hydro One Networks Inc. nor any of its affiliates assumes liability for any errors or omissions.  
 Produced by Hydro One under license with the Ontario Ministry of Natural Resources © Queen's Printer for Ontario, 2021.  
 NOT TO BE REPRODUCED OR REDISTRIBUTED CONFIDENTIAL TO HYDRO ONE NETWORKS INC.

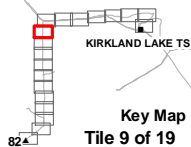

<ul style="list-style-type: none"> <li>■ Transformer Station</li> <li>▲ New Structure (Replacement/Relocation)</li> <li>▲ New Temporary</li> <li>▲ Existing Structure</li> </ul>	<ul style="list-style-type: none"> <li>— Existing 115 kV Transmission Line (K4)</li> <li>— New Parallel Replacement 115 kV Transmission Line (K4)</li> <li>- - - Other Transmission Lines</li> </ul>	<ul style="list-style-type: none"> <li>— Highway</li> <li>— Road</li> <li>— Railway</li> <li>- - - Pipeline</li> </ul>	<ul style="list-style-type: none"> <li>— Watercourse</li> <li>— Waterbody</li> <li>— Municipal Boundary</li> </ul>	<p><b>Circuit K4 Line Refurbishment - Kirkland Lake TS to Structure 82</b></p> <p>1:2,500</p>  
--	--	--	--	---

Town of  
Kirkland Lake

▲ 51 51

▲ 52 52

▲ 53 53

▲ 54 54

K4

- Transformer Station
- ▲ New Structure (Replacement/Relocation)
- ▲ New Temporary
- ▲ Existing Structure

- Existing 115 kV Transmission Line (K4)
- New Parallel Replacement 115 kV Transmission Line (K4)
- - - Other Transmission Lines

- Highway
- Road
- Railway
- - - Pipeline

- Watercourse
- Waterbody
- Municipal Boundary

**Circuit K4 Line Refurbishment - Kirkland Lake TS to Structure 82**

Town of Kirkland Lake

▲ 54 54

▲ 55 55

▲ 56 56

K4

hydro One  
 Produced By: Hydro One Networks Inc., GIS Services  
 Date: May 25, 2022  
 Map22-047\_K4\_Line\_Refurbishment\_Project\_Tile\_Map\_Ortho  
 (C) Copyright Hydro One Networks Inc. All rights reserved. No part of this drawing may be redistributed or reproduced in any form by any photographic, electronic, mechanical or any other means or used in any illustration, storage or retrieval system. Neither Hydro One Networks Inc. nor any of its affiliates assumes liability for any errors or omissions.  
 Produced by Hydro One under license with the Ontario Ministry of Natural Resources © Queen's Printer for Ontario, 2021.  
 NOT TO BE REPRODUCED OR REDISTRIBUTED CONFIDENTIAL TO HYDRO ONE NETWORKS INC.

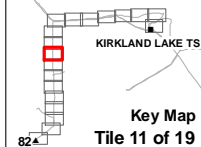

- Transformer Station
- ▲ New Structure (Replacement/Relocation)
- ▲ New Temporary
- ▲ Existing Structure
- Existing 115 kV Transmission Line (K4)
- New Parallel Replacement 115 kV Transmission Line (K4)
- - - Other Transmission Lines
- Highway
- Road
- Railway
- - - Pipeline
- Watercourse
- Waterbody
- ▭ Municipal Boundary

**Circuit K4 Line Refurbishment - Kirkland Lake TS to Structure 82**

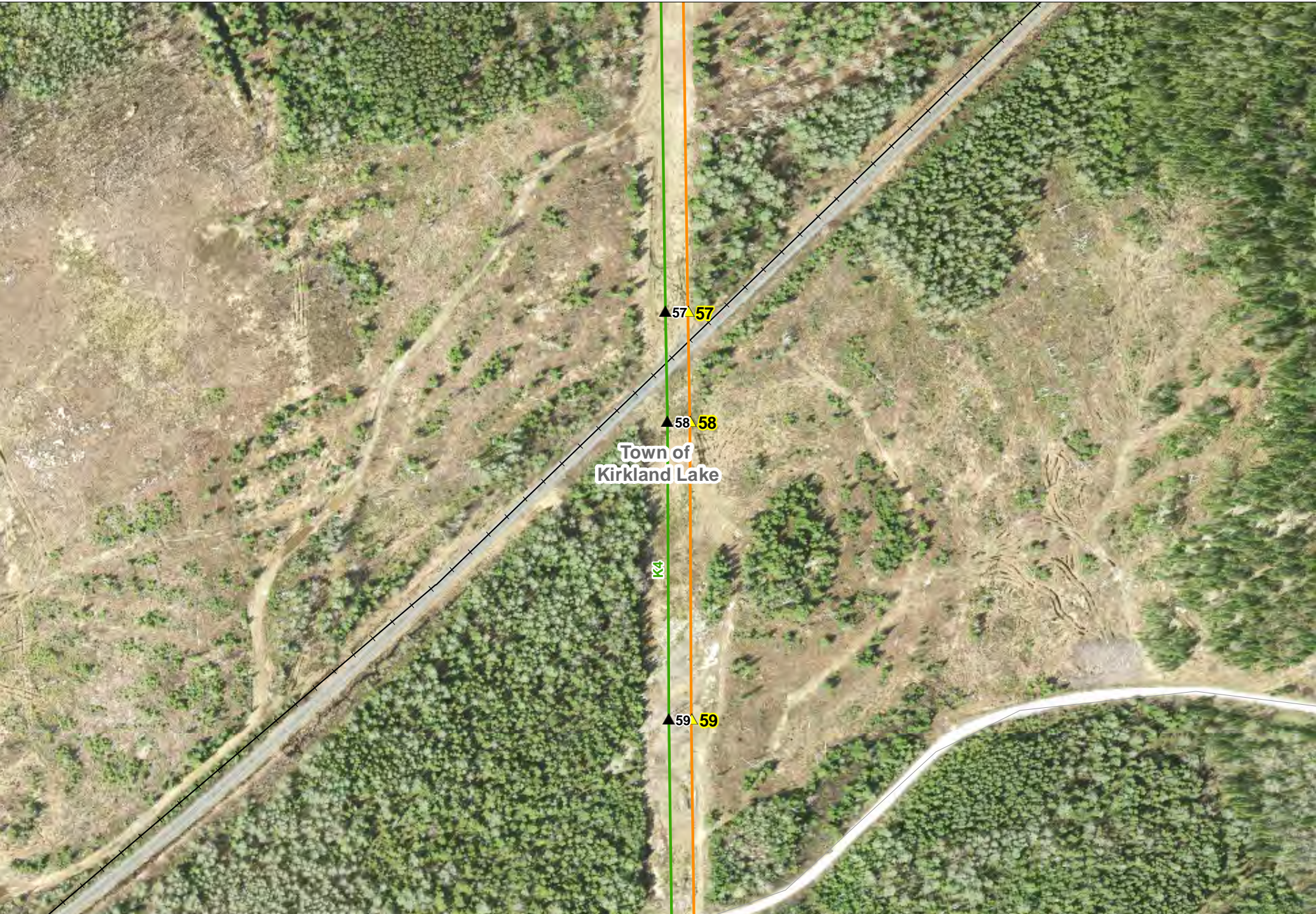

1:2,500



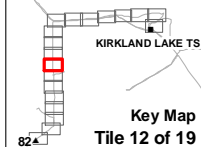

  
 Produced By: Hydro One Networks Inc., GIS Services
   
 Date: May 25, 2022
   
 Map22-047\_K4\_Line\_Refurbishment\_Projct\_Tile\_Map\_Ortho
   

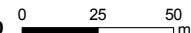
 (C) Copyright Hydro One Networks Inc. All rights reserved. No part of this drawing may be redistributed or reproduced in any form by any photographic, electronic, mechanical or any other means or used in any information storage or retrieval system. Neither Hydro One Networks Inc. nor any of its affiliates assumes liability for any errors or omissions.
   
 Produced by Hydro One under license with the Ontario Ministry of Natural Resources
   
 © Queen's Printer for Ontario, 2021.
   
 NOT TO BE REPRODUCED OR REDISTRIBUTED CONFIDENTIAL TO HYDRO ONE NETWORKS INC.



<ul style="list-style-type: none"> <li><span style="display: inline-block; width: 10px; height: 10px; background-color: gray; border: 1px solid black; margin-right: 5px;"></span> Transformer Station</li> <li><span style="display: inline-block; width: 10px; height: 10px; background-color: yellow; border: 1px solid black; margin-right: 5px;"></span> New Structure (Replacement/Relocation)</li> <li><span style="display: inline-block; width: 10px; height: 10px; background-color: purple; border: 1px solid black; margin-right: 5px;"></span> New Temporary</li> <li><span style="display: inline-block; width: 10px; height: 10px; background-color: black; border: 1px solid black; margin-right: 5px;"></span> Existing Structure</li> </ul>	<ul style="list-style-type: none"> <li><span style="display: inline-block; width: 20px; border-bottom: 2px solid green; margin-right: 5px;"></span> Existing 115 kV Transmission Line (K4)</li> <li><span style="display: inline-block; width: 20px; border-bottom: 2px solid orange; margin-right: 5px;"></span> New Parallel Replacement 115 kV Transmission Line (K4)</li> <li><span style="display: inline-block; width: 20px; border-bottom: 2px dashed black; margin-right: 5px;"></span> Other Transmission Lines</li> </ul>	<ul style="list-style-type: none"> <li><span style="display: inline-block; width: 20px; border-bottom: 2px solid brown; margin-right: 5px;"></span> Highway</li> <li><span style="display: inline-block; width: 20px; border-bottom: 2px solid gray; margin-right: 5px;"></span> Road</li> <li><span style="display: inline-block; width: 20px; border-bottom: 2px solid black; margin-right: 5px; position: relative; top: -2px;"><span style="position: absolute; top: 50%; left: -50%; transform: translate(-50%, -50%); font-size: 2px;">+</span></span> Railway</li> <li><span style="display: inline-block; width: 20px; border-bottom: 2px dashed red; margin-right: 5px;"></span> Pipeline</li> </ul>	<ul style="list-style-type: none"> <li><span style="display: inline-block; width: 20px; border-bottom: 2px solid lightblue; margin-right: 5px;"></span> Watercourse</li> <li><span style="display: inline-block; width: 20px; height: 10px; background-color: lightblue; border: 1px solid black; margin-right: 5px;"></span> Waterbody</li> <li><span style="display: inline-block; width: 20px; border: 1px solid gray; margin-right: 5px;"></span> Municipal Boundary</li> </ul>	<p><b>Circuit K4 Line Refurbishment - Kirkland Lake TS to Structure 82</b></p> <p>1:2,500</p>  
---	---	---	---	---



  
 Produced By: Hydro One Networks Inc., GIS Services  
 Date: May 25, 2022  
 Map22-047\_K4\_Line\_Refurbishment\_Projct\_Tile\_Map\_Ortho  
 (C) Copyright Hydro One Networks Inc. All rights reserved. No part of this drawing may be redistributed or reproduced in any form by any photographic, electronic, mechanical or any other means or used in any information storage or retrieval systems. Neither Hydro One Networks Inc. nor any of its affiliates assumes liability for any errors or omissions.  
 Produced by Hydro One under license with the Ontario Ministry of Natural Resources © Queen's Printer for Ontario, 2021.  
 NOT TO BE REPRODUCED OR REDISTRIBUTED CONFIDENTIAL TO HYDRO ONE NETWORKS INC.

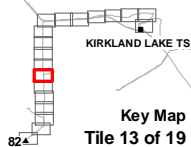

- Transformer Station
- New Structure (Replacement/Relocation)
- New Temporary
- Existing Structure
- Existing 115 kV Transmission Line (K4)
- New Parallel Replacement 115 kV Transmission Line (K4)
- Other Transmission Lines

- Highway
- Road
- Railway
- Pipeline
- Watercourse
- Waterbody
- Municipal Boundary

**Circuit K4 Line Refurbishment - Kirkland Lake TS to Structure 82**

1:2,500 0 25 50 m









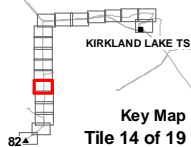







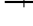

  
 Produced By: Hydro One Networks Inc., GIS Services
   
 Date: May 25, 2022
   
 Map22-047\_K4\_Line\_Refurbishment\_Projct\_Tile\_Map\_Ortho
   

 (C) Copyright Hydro One Networks Inc. All rights reserved. No part of this drawing may be redistributed or reproduced in any form by any photographic, electronic, mechanical or any other means or used in any illustration, storage or retrieval system. Neither Hydro One Networks Inc. nor any of its affiliates assumes liability for any errors or omissions.
   
 Produced by Hydro One under license with the Ontario Ministry of Natural Resources
   
 © Queen's Printer for Ontario, 2021.
   
 NOT TO BE REPRODUCED OR REDISTRIBUTED CONFIDENTIAL TO HYDRO ONE NETWORKS INC.

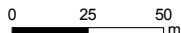

- |  |  |  |  |
|--|--|--|--|
| <ul style="list-style-type: none"> <li> Transformer Station</li> <li> New Structure (Replacement/Relocation)</li> <li> New Temporary</li> <li> Existing Structure</li> </ul> | <ul style="list-style-type: none"> <li> Existing 115 kV Transmission Line (K4)</li> <li> New Parallel Replacement 115 kV Transmission Line (K4)</li> <li> Other Transmission Lines</li> </ul> | <ul style="list-style-type: none"> <li> Highway</li> <li> Road</li> <li> Railway</li> <li> Pipeline</li> </ul> | <ul style="list-style-type: none"> <li> Watercourse</li> <li> Waterbody</li> <li> Municipal Boundary</li> </ul> |
|--|--|--|--|

**Circuit K4 Line Refurbishment - Kirkland Lake TS to Structure 82**

1:2,500
 



Town of Kirkland Lake

▲65 65

K4

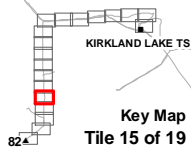

  
 Produced By: Hydro One Networks Inc., GIS Services  
 Date: May 25, 2022  
 Map22-047\_K4\_Line\_Refurbishment\_Projct\_Tile\_Map\_Ortho  
 (C) Copyright Hydro One Networks Inc. All rights reserved. No part of this drawing may be redistributed or reproduced in any form by any photographic, electronic, mechanical or any other means or used in any information storage or retrieval systems. Neither Hydro One Networks Inc. nor any of its affiliates assumes liability for any errors or omissions.  
 Produced by Hydro One under license with the Ontario Ministry of Natural Resources © Queen's Printer for Ontario, 2021.  
 NOT TO BE REPRODUCED OR REDISTRIBUTED CONFIDENTIAL TO HYDRO ONE NETWORKS INC.



- |  |  |  |  |
|--|--|--|--|
| <ul style="list-style-type: none"> <li>■ Transformer Station</li> <li>▲ New Structure (Replacement/Relocation)</li> <li>▲ New Temporary</li> <li>▲ Existing Structure</li> </ul> | <ul style="list-style-type: none"> <li>— Existing 115 kV Transmission Line (K4)</li> <li>— New Parallel Replacement 115 kV Transmission Line (K4)</li> <li>- - - Other Transmission Lines</li> </ul> | <ul style="list-style-type: none"> <li>— Highway</li> <li>— Road</li> <li>— Railway</li> <li>- - - Pipeline</li> </ul> | <ul style="list-style-type: none"> <li>— Watercourse</li> <li>— Waterbody</li> <li>▭ Municipal Boundary</li> </ul> |
|--|--|--|--|

**Circuit K4 Line Refurbishment - Kirkland Lake TS to Structure 82**

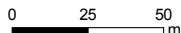
1:2,500



  
 Produced By: Hydro One Networks Inc., GIS Services
   
 Date: May 25, 2022
   
 Map22-047\_K4\_Line\_Refurbishment\_Projct\_Tile\_Map\_Ortho
   

 (C) Copyright Hydro One Networks Inc. All rights reserved. No part of this drawing may be
 redistributed or reproduced in any form by any photographic, electronic, mechanical or any
 other means or used in any information storage or retrieval systems. Neither Hydro One
 Networks Inc. nor any of its affiliates assumes liability for any errors or omissions.
 Produced by Hydro One under license with the Ontario Ministry of Natural Resources
 © Queen's Printer for Ontario, 2021.
 NOT TO BE REPRODUCED OR REDISTRIBUTED CONFIDENTIAL TO HYDRO ONE NETWORKS INC.



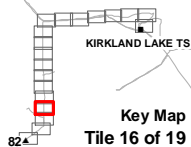

- |   |   |   |   |
|---|---|---|---|
| <ul style="list-style-type: none"> <li><span style="display: inline-block; width: 10px; height: 10px; background-color: gray; border: 1px solid black; margin-right: 5px;"></span> Transformer Station</li> <li><span style="display: inline-block; width: 10px; height: 10px; background-color: yellow; border: 1px solid black; margin-right: 5px;"></span> New Structure (Replacement/Relocation)</li> <li><span style="display: inline-block; width: 10px; height: 10px; background-color: purple; border: 1px solid black; margin-right: 5px;"></span> New Temporary</li> <li><span style="display: inline-block; width: 10px; height: 10px; background-color: black; border: 1px solid black; margin-right: 5px;"></span> Existing Structure</li> </ul> | <ul style="list-style-type: none"> <li><span style="display: inline-block; width: 20px; border-bottom: 2px solid green; margin-right: 5px;"></span> Existing 115 kV Transmission Line (K4)</li> <li><span style="display: inline-block; width: 20px; border-bottom: 2px solid orange; margin-right: 5px;"></span> New Parallel Replacement 115 kV Transmission Line (K4)</li> <li><span style="display: inline-block; width: 20px; border-bottom: 2px dashed black; margin-right: 5px;"></span> Other Transmission Lines</li> </ul> | <ul style="list-style-type: none"> <li><span style="display: inline-block; width: 20px; border-bottom: 2px solid gray; margin-right: 5px;"></span> Highway</li> <li><span style="display: inline-block; width: 20px; border-bottom: 1px solid gray; margin-right: 5px;"></span> Road</li> <li><span style="display: inline-block; width: 20px; border-bottom: 1px dashed gray; margin-right: 5px;"></span> Railway</li> <li><span style="display: inline-block; width: 20px; border-bottom: 2px dashed red; margin-right: 5px;"></span> Pipeline</li> </ul> | <ul style="list-style-type: none"> <li><span style="display: inline-block; width: 20px; border-bottom: 2px solid lightblue; margin-right: 5px;"></span> Watercourse</li> <li><span style="display: inline-block; width: 20px; background-color: lightblue; height: 10px; margin-right: 5px;"></span> Waterbody</li> <li><span style="display: inline-block; width: 20px; border: 1px dashed gray; margin-right: 5px;"></span> Municipal Boundary</li> </ul> |
|---|---|---|---|

**Circuit K4 Line Refurbishment - Kirkland Lake TS to Structure 82**

1:2,500

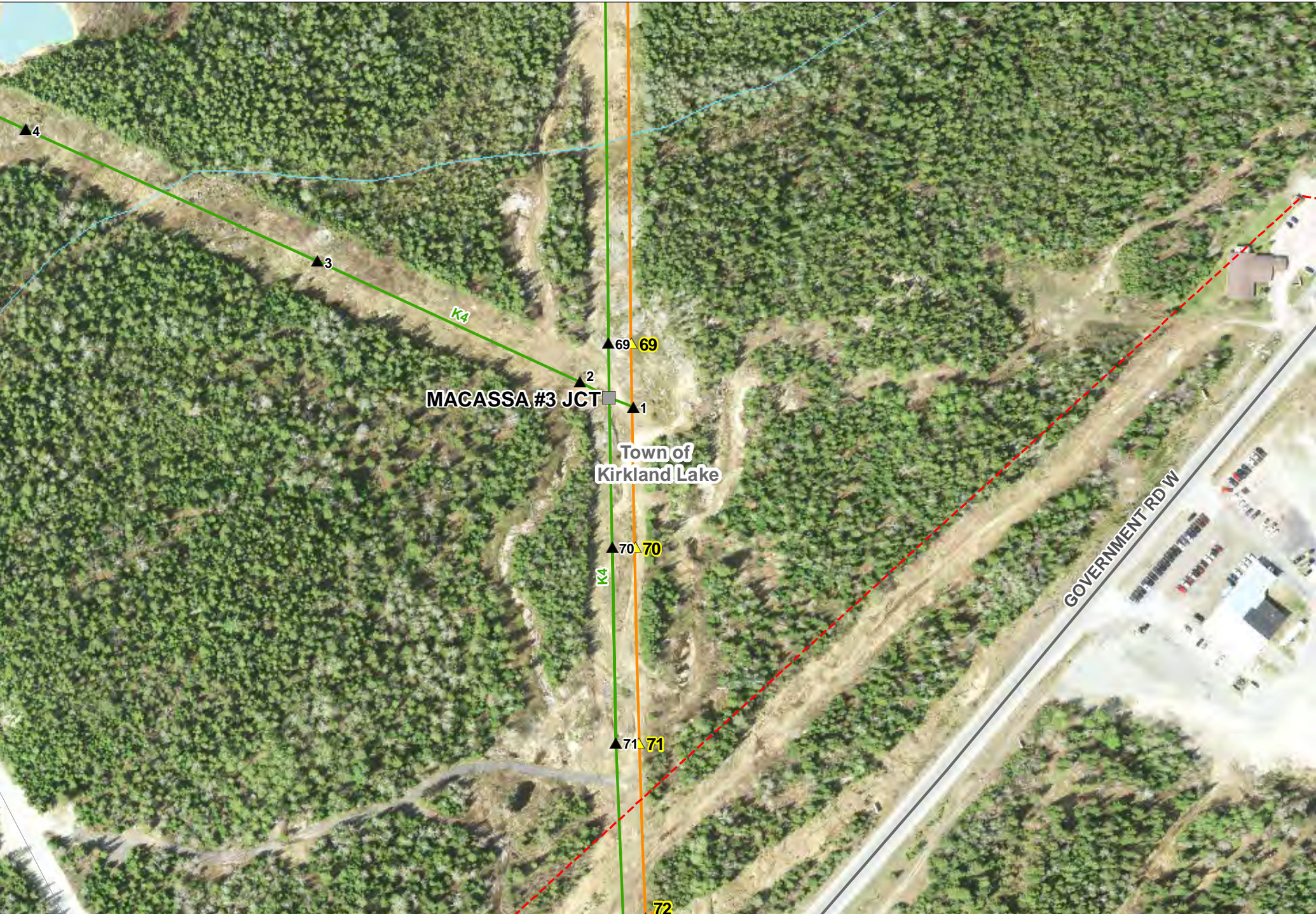



  
 Produced By: Hydro One Networks Inc., GIS Services
   
 Date: May 25, 2022
   
 Map22-047\_K4\_Line\_Refurbishment\_Projct\_Tile\_Map\_Ortho
   

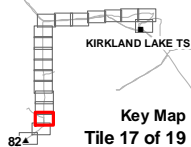

 (C) Copyright Hydro One Networks Inc. All rights reserved. No part of this drawing may be redistributed or reproduced in any form by any photographic, electronic, mechanical or any other means or used in any information storage or retrieval system. Neither Hydro One Networks Inc. nor any of its affiliates assumes liability for any errors or omissions.
   
 Produced by Hydro One under license with the Ontario Ministry of Natural Resources
   
 © Queen's Printer for Ontario, 2021.
   
 NOT TO BE REPRODUCED OR REDISTRIBUTED CONFIDENTIAL TO HYDRO ONE NETWORKS INC.



- Transformer Station
- New Structure (Replacement/Relocation)
- New Temporary
- Existing Structure
- Existing 115 kV Transmission Line (K4)
- New Parallel Replacement 115 kV Transmission Line (K4)
- Other Transmission Lines

- Highway
- Road
- Railway
- Pipeline
- Watercourse
- Waterbody
- Municipal Boundary

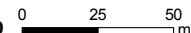
**Circuit K4 Line Refurbishment - Kirkland Lake TS to Structure 82**





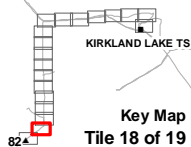

1:2,500
   

  

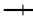

  
 Produced By: Hydro One Networks Inc., GIS Services  
 Date: May 25, 2022  
 Map22-047\_K4\_Line\_Refurbishment\_Projct\_Tile\_Map\_Ortho  
 (C) Copyright Hydro One Networks Inc. All rights reserved. No part of this drawing may be redistributed or reproduced in any form by any photographic, electronic, mechanical or any other means or used in any illustration, storage or retrieval system. Neither Hydro One Networks Inc. nor any of its affiliates assumes liability for any errors or omissions.  
 Produced by Hydro One under license with the Ontario Ministry of Natural Resources © Queen's Printer for Ontario, 2021.  
 NOT TO BE REPRODUCED OR REDISTRIBUTED CONFIDENTIAL TO HYDRO ONE NETWORKS INC.





-  Transformer Station
-  New Structure (Replacement/Relocation)
-  New Temporary
-  Existing Structure
-  Existing 115 kV Transmission Line (K4)
-  New Parallel Replacement 115 kV Transmission Line (K4)
-  Other Transmission Lines

-  Highway
-  Road
-  Railway
-  Pipeline
-  Watercourse
-  Waterbody
-  Municipal Boundary

**Circuit K4 Line Refurbishment - Kirkland Lake TS to Structure 82**

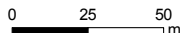
1:2,500



  
 Produced By: Hydro One Networks Inc., GIS Services  
 Date: May 25, 2022  
 Map22-047\_K4\_Line\_Refurbishment\_Project\_Tile\_Map\_Ortho  
 (C) Copyright Hydro One Networks Inc. All rights reserved. No part of this drawing may be redistributed or reproduced in any form by any photographic, electronic, mechanical or any other means or used in any information storage or retrieval system. Neither Hydro One Networks Inc. nor any of its affiliates assumes liability for any errors or omissions.  
 Produced by Hydro One under license with the Ontario Ministry of Natural Resources © Queen's Printer for Ontario, 2021.  
 NOT TO BE REPRODUCED OR REDISTRIBUTED CONFIDENTIAL TO HYDRO ONE NETWORKS INC.

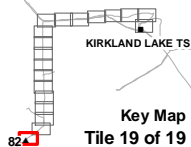

- Transformer Station
- New Structure (Replacement/Relocation)
- New Temporary
- Existing Structure
- Existing 115 kV Transmission Line (K4)
- New Parallel Replacement 115 kV Transmission Line (K4)
- Other Transmission Lines

- Highway
- Road
- Railway
- Pipeline
- Watercourse
- Waterbody
- Municipal Boundary

**Circuit K4 Line Refurbishment - Kirkland Lake TS to Structure 82**  
 1:2,500  
